

Shirakaba Terrace House

Commercial

Office / Shop

Tenanted

Osaka

Posted On 07-11-2019

📍 3 Chome Shirasagicho, Higashi Ward, Sakai, Osaka.

¥ 16,800,000

BUY

📍 Floor Area
48.00 m²

🏠 Layout
-

📅 Built Year
1973

📈 Gross Yield
7.86%

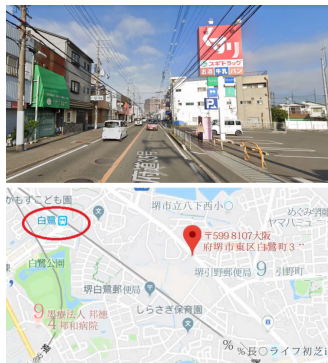
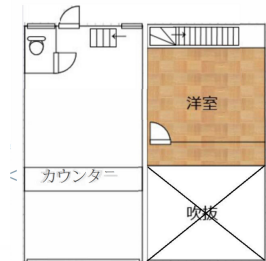







公众号





PROPERTY INFO

Building / Land Information

	Property Name:	Shirakaba Terrace House
	Address:	3 Chome Shirasagicho, Higashi Ward, Sakai, Osaka.
	Land Ownership:	Freehold
	Building Structure:	Wooden
	Built Year:	1973
	Land Area:	39.02 m ² / 420.01 ft ²

Unit Information

	Layout:	-
	Floor Area:	48.00 m ² / 516.67 ft ²
	Occupancy Status:	Tenanted

Additional Information

Note 1: Take away food store

Location Information

	Transportation:	Shirasagi station / 11 minutes walking distance
---	-----------------	---



INCOME & EXPENSE

	Monthly	Annually
Rental Income:	¥110,000	¥1,320,000
Building Management Fee:	-¥0	-¥0
Building Sinking Fund:	-¥0	-¥0
Other Miscellaneous Fee:	-¥0	-¥0
Agency Management Fee:	-¥6,050	-¥72,600
Annual Fixed Asset & City Planning Tax (Estimated):	-	-¥60,000
Net Rental Income After Tax:		¥1,187,400

COST OF PURCHASE

	Offer Price	3%↓ Offer Price	5%↓ Offer Price
Purchase Price:	¥16,800,000	¥16,296,000	¥15,960,000
Land Registration & Legal Fee (Estimated):	¥160,000		
Agency Brokerage Fee:	¥620,400	¥603,768	¥592,680
Total Cost of Purchase:	¥17,580,400	¥17,059,768	¥16,712,680

RENTAL YIELD

	Offer Price	3%↓ Offer Price	5%↓ Offer Price
Purchase Price:	¥16,800,000	¥16,296,000	¥15,960,000
Gross Rental Yield:	7.86%	8.10%	8.27%
Net Rental Yield:	7.10%	7.31%	7.47%

